



«Drive&ride culture» development centers



26 spMotoParks

The National chain of **EV auto-moto-go-kart Centers and SIM classrooms** for education, sports, professional training and entertainment with multi-level reconfigured indoor tracks and/or outdoor classical circuits in all regions of Ukraine including Kyiv City, the Capital





CONCEPTUAL DESIGN

Physical Ecosystem

spMotoPark

*The Conceptual design of "The Digital Ecosystem" is contained in a separate document, however, we provide here some short fragments without any detailings as to business and financial models.





This is a referential model/solution for each of 26 Centers (circuits) for «National Network of spMotoParks, Ukraine». Each Center is a separate regional project with the local communities involved and comprised in projects catalogue under spMotoPark, <region> name.

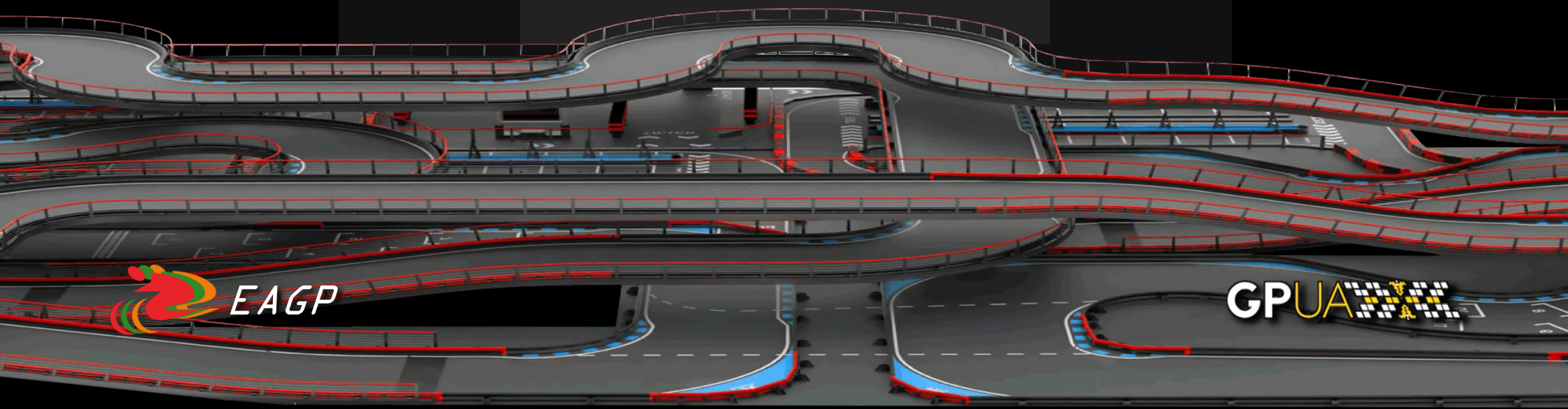
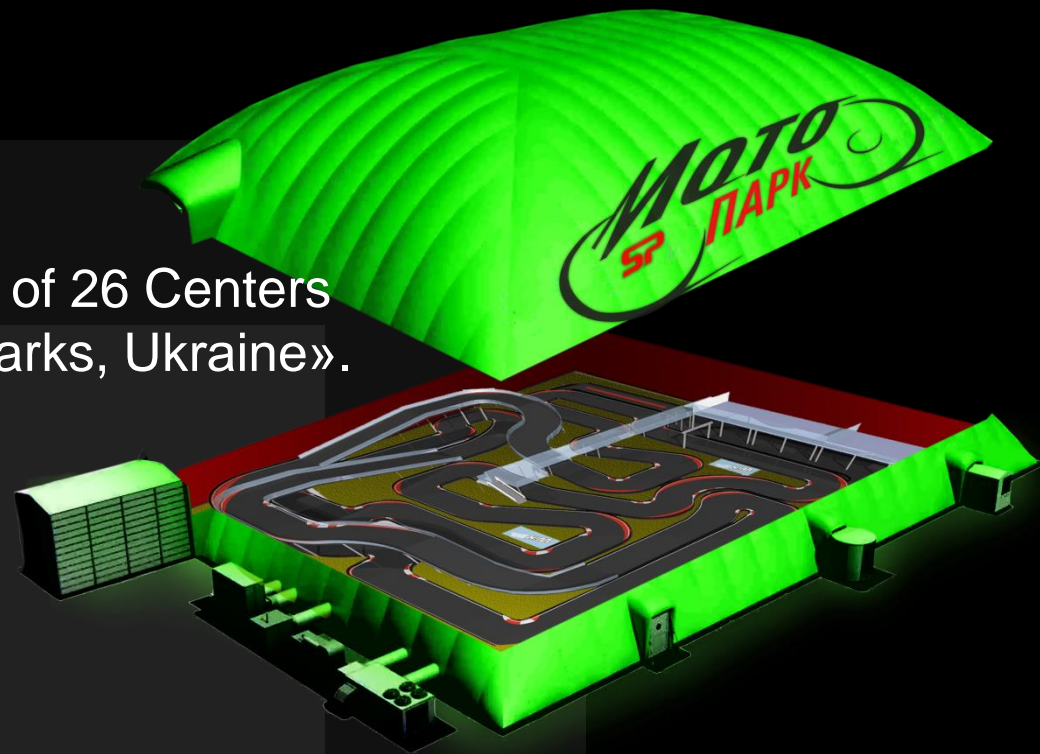



Project mission

*«Drive&ride culture» cultivation, i.e.
Social, sports, professional development of citizens.
Active family leisure and entertainment.*

The purpose and objectives of the project

Development, implementation, and operation of a highly profitable Physical network of indoor and/or outdoor tracks with EV auto-moto-karting and SIM-driving-racing Centers as well as its Digital twin on the territory of Ukraine for school education, sports, professional training, entertainment, and family leisure.





Terms of Project implementation in Kyiv or region - 1 year

The Project will start in July 2020.

The format of the full-scale project is National, covering all regional centers

The Project has been implementing due to the initiative and with the participation of the Non Profit Association (NPA) Grand Prix Ukraine. Its deployment is carrying out by a narrow focused Special Purpose Vehicle company (SPV), endowed with project management functions. This body also is an intellectual property owner and has all land ownership rights, stake in the equity capital of similar regional projects, facilities operating rights.



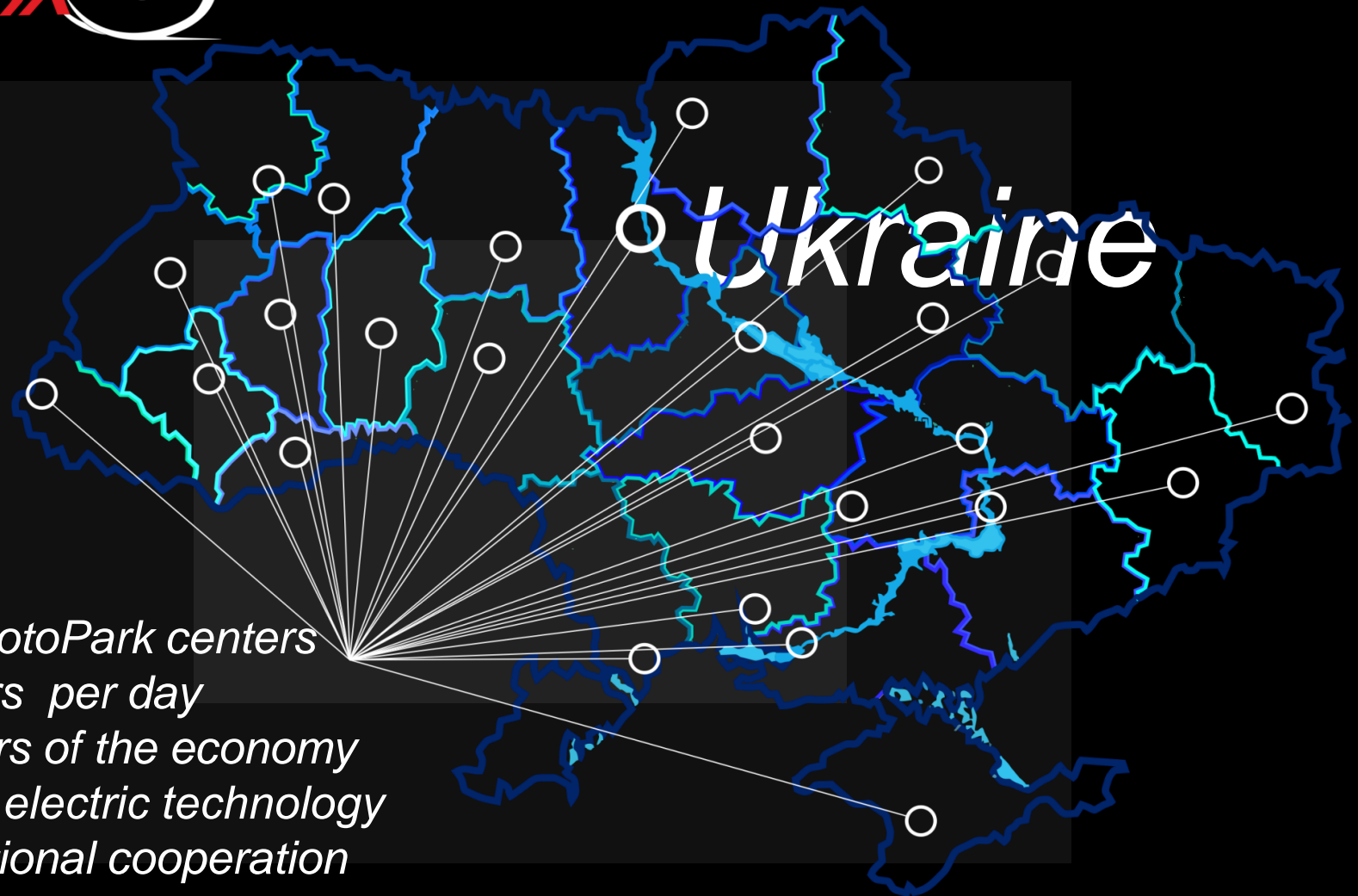

- *26 spMotoPark centers*
- *24 hours per day*
- *5 sectors of the economy*
- *“green” electric technology*
- *international cooperation*





Physical ecosystem

Center's format

City

Track: indoor
Size: 2 hectares
Building : 100x40x12 m
E sport Arena – Training classes
Food-zone
Fitness

Club

Track: mix (indoor+outdoor)
Size 10 hectares
Length: 2.5 km
Width: 8-12 m
+

City





City: inner space zoning

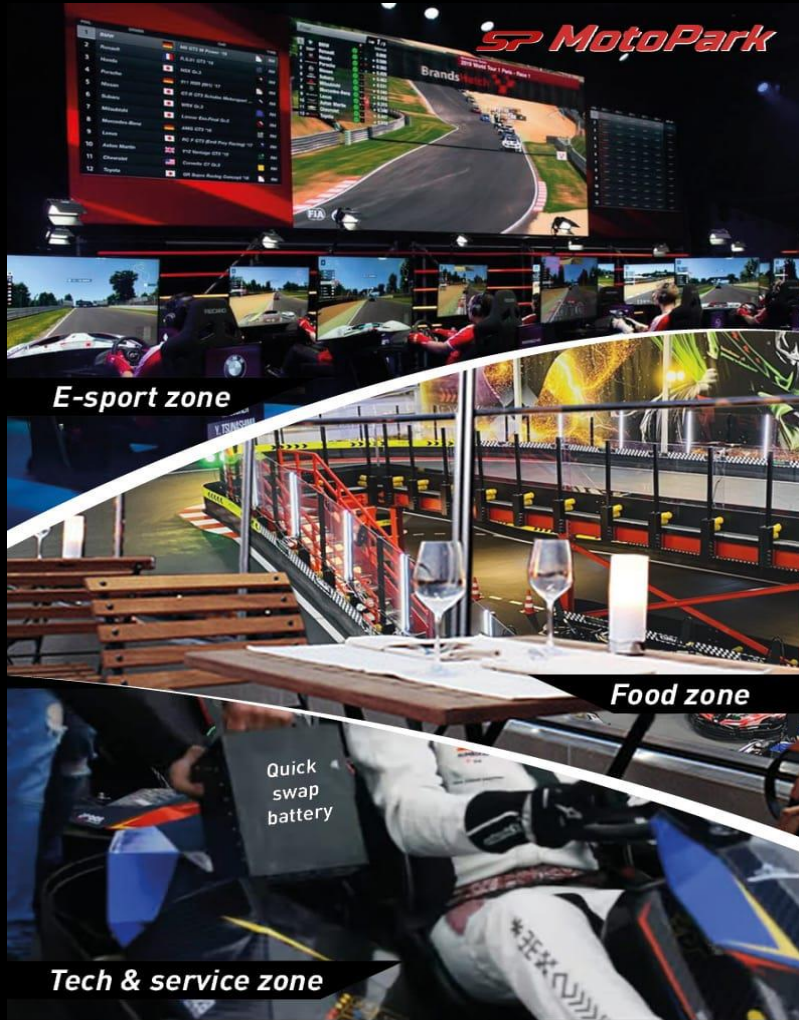



City: inner space zoning
Electric go-kart charging stations

Tech & Service Zone.





City: inner space zoning

E-sport zone

E-sport Zone





City: inner space zoning
Education and admin zone

Admin Zone





Digital ecosystem «Home work»





Digital ecosystem City's digital models

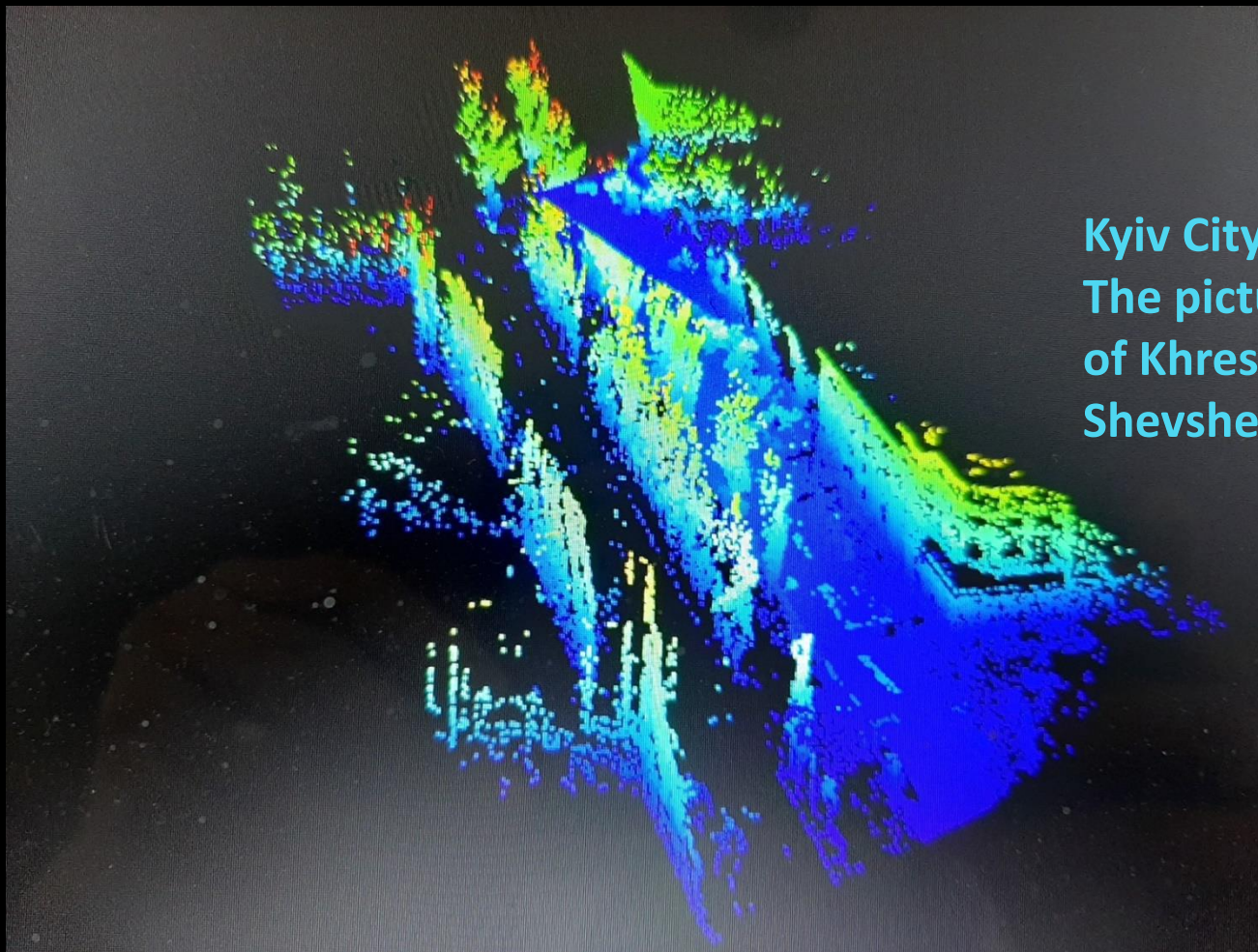

Kyiv City in the point clouds .
The picture shows an intersection
of Khreshatik Str. with
Shevshenko Blv.





Digital ecosystem Track's digital model

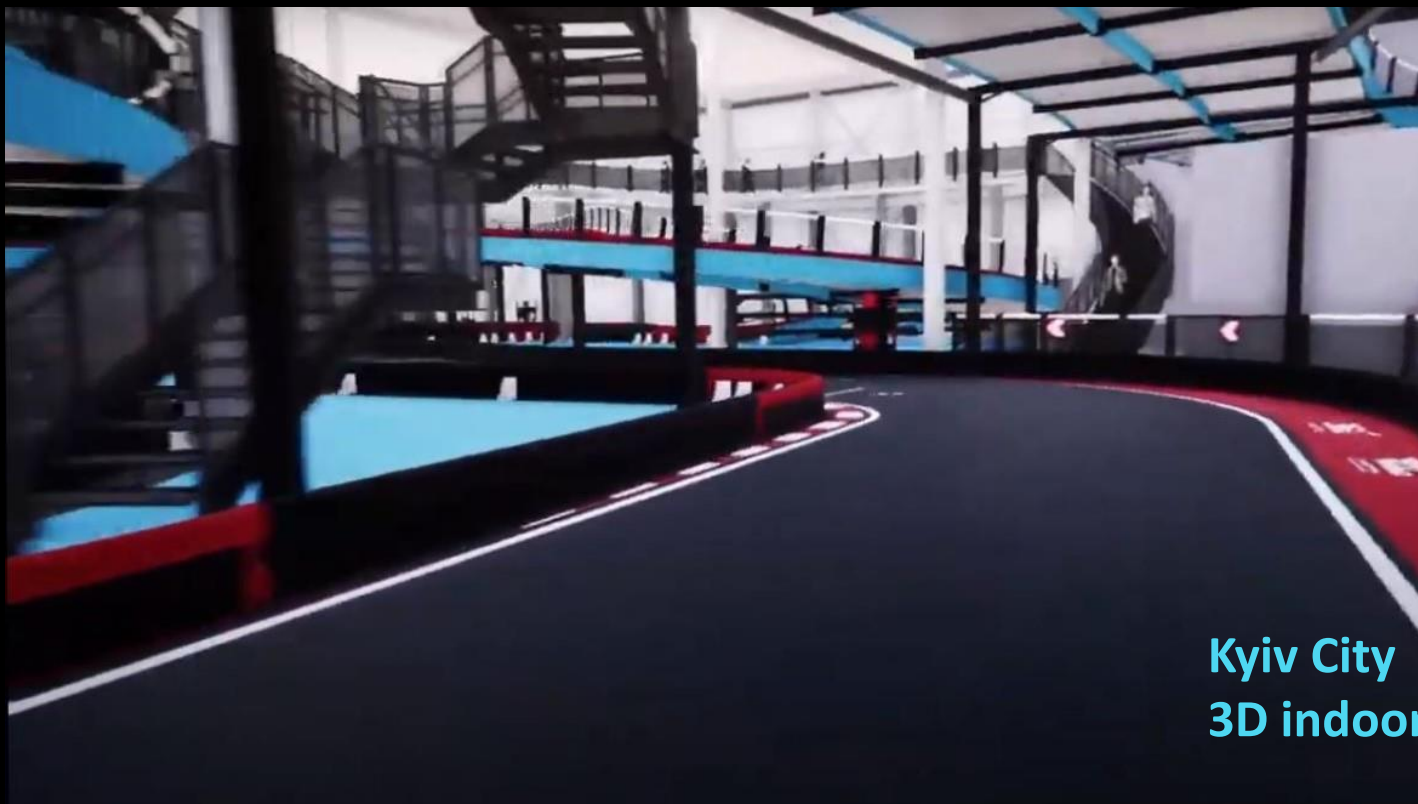

Kyiv City
3D indoor track model



Project company: competences, partners, stakeholders



Technologies

Production companies
Joint ventures
CyberSport s' racings
Service companies

Institutions

President's office
Parliament 's (Rada) committees
Regional and cities' communities,
Ministries, agencies
Other countries

Financing

Banks

- Project company stakeholder
- Debt financing, loans
- Securities

Private equity firms

Venture companies

Leasing

Experience and methodologies

Schools, academies

- Secondary schools programs
- Sports methodologies
- Sports teams

Federations

- Licenses
- Competitions
- Racing series





Market coverage
Sectors of the economy

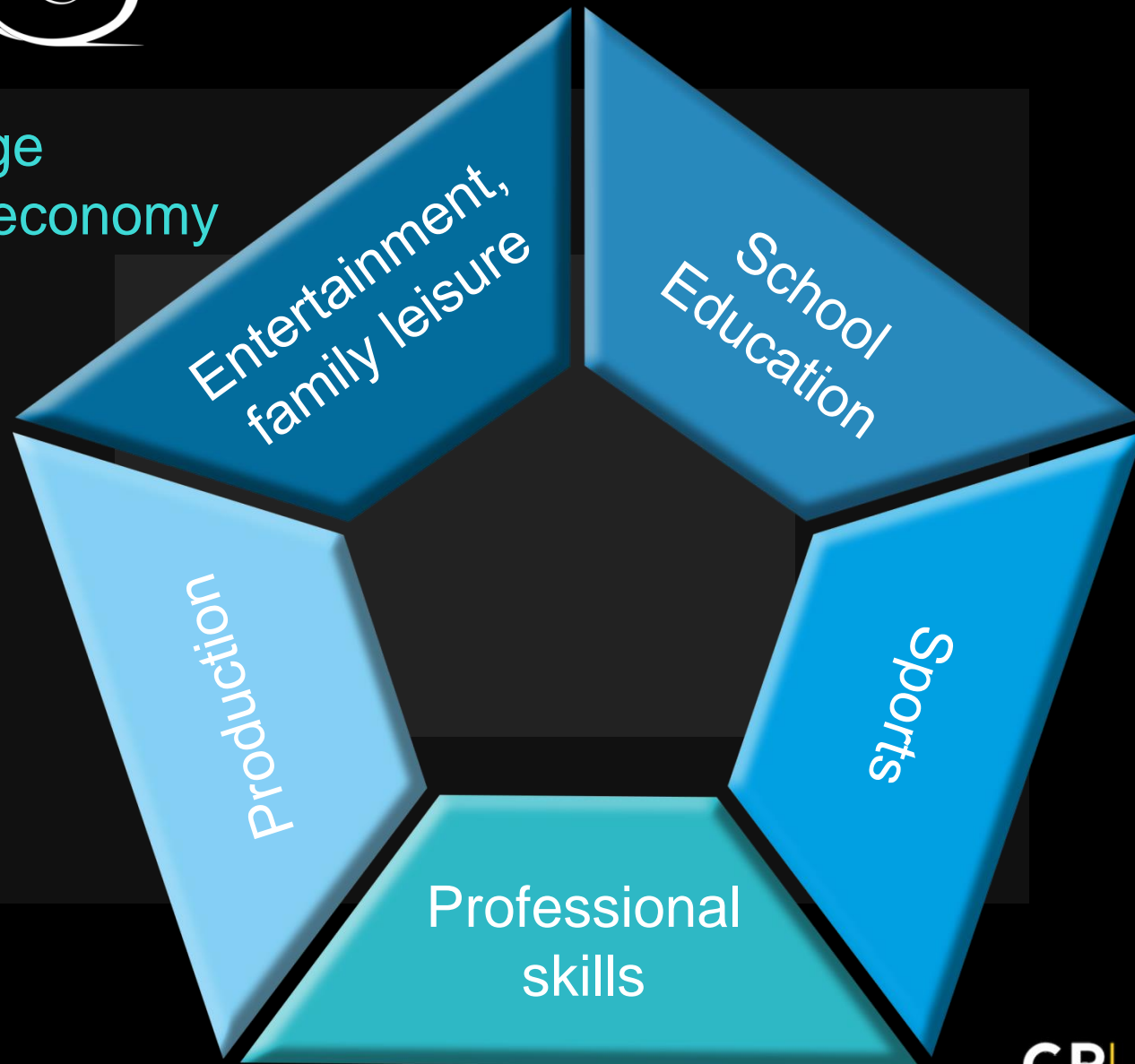



SWOT factors

STRENGTHS

- Comprehensive market coverage: education, sports, prof. training, entertainment/ family leisure
- Round-the-clock operation
- Network model with territorial coverage of the whole country; presence in each regional center
- Solid legal framework in the center and regions; territorial communities participation

WEAKNESSES

- Complexity and duration of implementation
- High capital requirements

OPPORTUNITIES

- The international cooperation
- Interstate status of the project
- Licensing
- Road to big tracks

THREATS

- Weak purchasing power
- Macroeconomic instability
- Epidemic

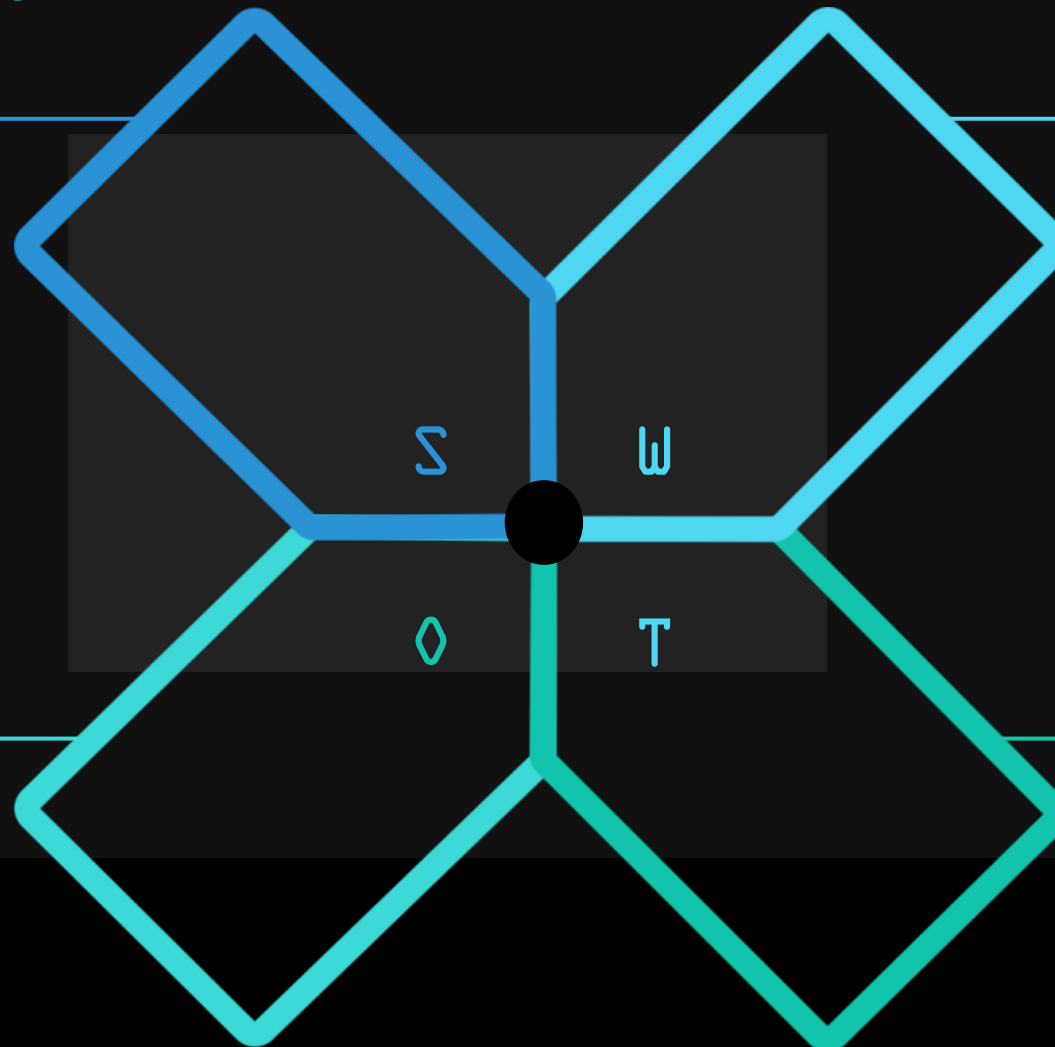



Alternative infrastructure components of the City project and options for design solutions

Building

Construction options:

- Air inflated, AI
- Frame, fast mounted
- Arena

Circuit

Installation options:

- layers
- length
- complexity
- zoning for prof., adults, kids&juniors, families

Electric vehicle (EV)

Vary according to the capacity/ category of EV and the level of pilots skills

electro go-kart
electro bike
electro minimoto

kids
juniors
adults
prof.





Building: track zone
air inflated

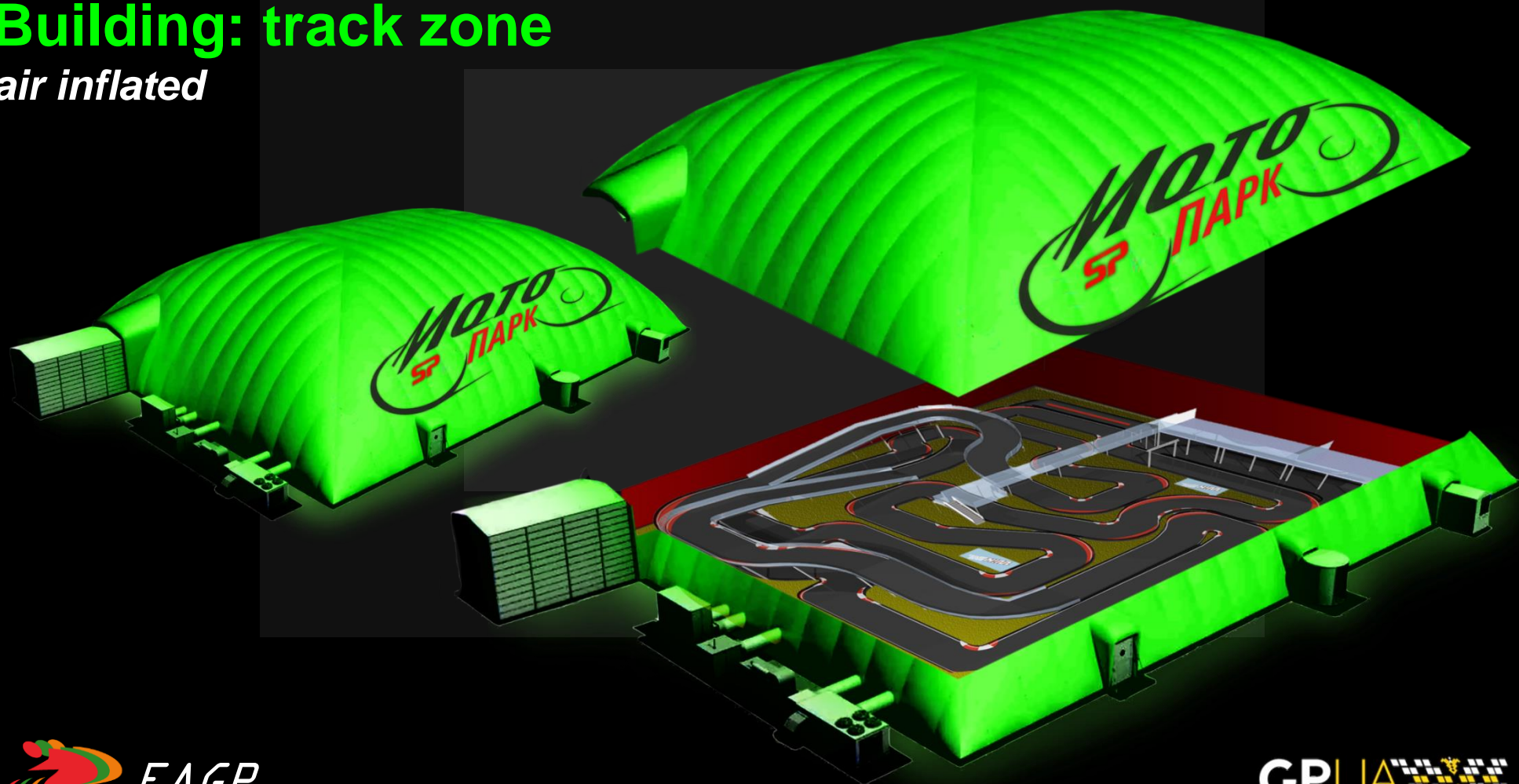



Building: track zone
framed, fast mounted

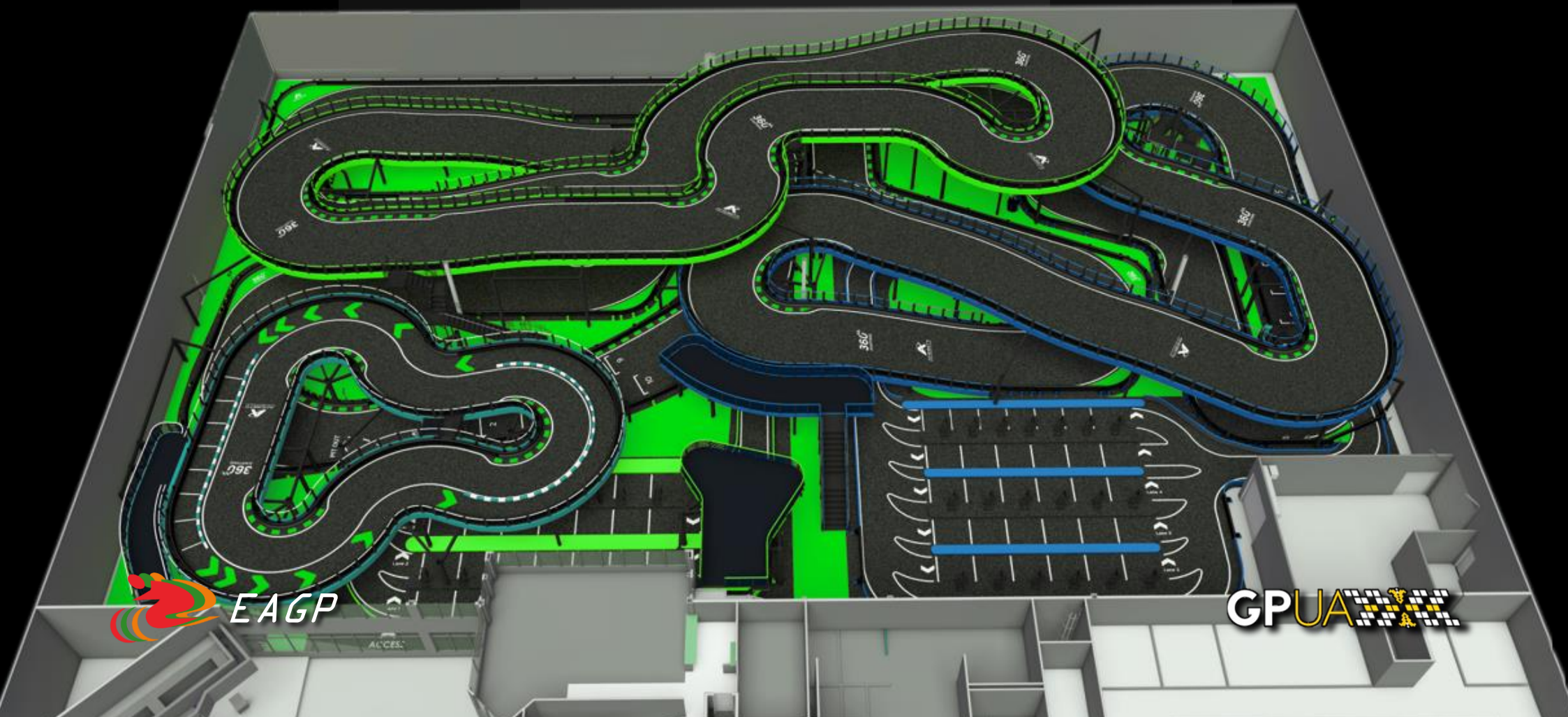



Building: track zone
framed, fast mounted





Building: track zone

Arena

It is focused on megacities and cities locations with at least 1M population with high effective demand, traditions of (night) clubbing and steady customer flow, which provides simultaneous use on 3 connected or isolated routes up to 100 EV.

Licensed to other countries.

Valencia circuit -----

Nurburgring circuit-----

Silverstone circuit-----





Services supplied

- Individual rent
- Family, Groups & Corporate rent
- Sport, e-sport
- Secondary school education program
- Night racings following “go-kart vs pit bike” formula; EAGP license should be applied
- SPMoto Junior & Kids Race Academy
- Professional skills development program (patrol police, rescue and special forces teams) for extreme and secure vehicle riding/driving





SPMoto Junior & Kids Race Academy



"SP-Moto Juniors Motorcycle Race Academy (SPARC) shapes a future ecosystem and creates our Nation's winning spirit. It protects the coming generation against drugs, gadget-mania and gutless members.

Let's shape our future!"

Eugene Pisarev,
coach and road racing Champ



WHEN DO WE START TEACHING?

4-7 year olds



minibike, pitbike



mini cart

7-10 year olds



minibike, pitbike, supermoto, sportbike SSP300



midi cart

10-13 year olds

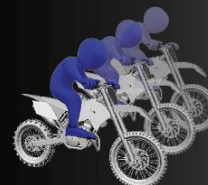

minibike, pitbike, supermoto, sportbike SSP300



profi cart

13-16 year olds



minibike, pitbike, supermoto, sportbike SSP300, SSP600



profi cart

Individuals over 16 year old



Individual Champs courses



profi cart

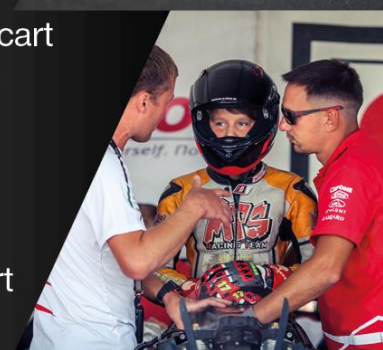



Patrol police training program

Goal :

Learning the skills of extreme motorcycle riding in conditions of active maneuvering, many obstacles and unpredictability. Development of stable psychomotor reactions and skills. Maintaining a high level of motorcycle riding habits, including off-season; readiness for service in all conditions. Enter to peak physical condition before the beginning of the spring-summer season.





Patrol police training program

...for extreme motorcycle riding skills															
First winter stage. Indoor track. Pitbike: class-20 h/rider; 6,5 weeks; 48 riders.															
WEEK															
1															
Day				Day				Day							
1				2				3							
Mon				Wed				Fri							
Time	Group	Session hr	Riders on track.	Time	Group	Session hr	Riders on track.	Time	Group	Session hr	Riders on track.				
7:30-9:30				7:30-9:30				7:30-9:30							
	A	2,00	3,00		I	2,00	3,00		A	2,00	3,00				
	B	2,00	3,00		J	2,00	3,00		B	2,00	3,00				
	C	2,00	3,00		K	2,00	3,00		C	2,00	3,00				
	D	2,00	3,00		L	2,00	3,00		D	2,00	3,00				
10-12				10-12				10-12							
	E	2,00	3,00		M	2,00	3,00		E	2,00	3,00				
	F	2,00	3,00		N	2,00	3,00		F	2,00	3,00				
	G	2,00	3,00		O	2,00	3,00		G	2,00	3,00				
	H	2,00	3,00		P	2,00	3,00		H	2,00	3,00				





City financial model (basics)

Capital expenses (CAPEX)

- Building, AI Infrastructure
- Track (design, production, installation)
- Electric vehicles

2 320 000 euro

Operating expenses per year (OPEX)

- Service & repair
- Energy, materials, spare parts
- Property maintenance
- Personal
- Loan payments, insurance

300 000 euro

Revenue per year

1 800 000 euro

Income Statement					
Revenue	1800000	1800000	1800000	1800000	1800000
Cost of Goods Sold (COGS)	200000	200000	200000	200000	200000
Gross Profit	1600000	1600000	1600000	1600000	1600000
Expenses					
Salaries and Benefits	200000	200000	200000	200000	200000
Rent and Overhead	100000	100000	100000	100000	100000
Depreciation & Amortization	150000	150000	150000	150000	150000
Interest	150000	150000	150000	150000	150000
Total Expenses	600000	600000	600000	600000	600000
Earnings Before Tax	1000000	1000000	1000000	1000000	1000000
Taxes	100000	100000	100000	100000	100000
Net Earnings	900000	900000	900000	900000	900000
Balance Sheet					
Assets					
Cash	100000	100000	100000	100000	100000
Accounts Receivable	100000	100000	100000	100000	100000
Inventory	100000	100000	100000	100000	100000
Property & Equipment	1000000	1000000	1000000	1000000	1000000
Total Assets	1300000	1300000	1300000	1300000	1300000
Liabilities					
Accounts Payable	100000	100000	100000	100000	100000
Debt	1000000	1000000	1000000	1000000	1000000
Total Liabilities	1100000	1100000	1100000	1100000	1100000
Shareholder's Equity					
Equity Capital	1000000	1000000	1000000	1000000	1000000
Retained Earnings	300000	300000	300000	300000	300000
Shareholder's Equity	1300000	1300000	1300000	1300000	1300000
Total Liabilities & Shareholder's Equity	1300000	1300000	1300000	1300000	1300000
Cash Flow Statement					
Operating Cash Flow					
Net Earnings	900000	900000	900000	900000	900000
Plus: Depreciation & Amortization	150000	150000	150000	150000	150000
Less: Changes in Working Capital	150000	150000	150000	150000	150000
Cash from Operations	900000	900000	900000	900000	900000
Investing Cash Flow					
Investments in Property & Equipment	(1000000)	(1000000)	(1000000)	(1000000)	(1000000)
Cash from Investing	(1000000)	(1000000)	(1000000)	(1000000)	(1000000)
Financing Cash Flow					
Issuance (repayment) of debt	0	0	0	0	0
Issuance (repayment) of equity	0	0	0	0	0
Cash from Financing	0	0	0	0	0
Net Increase (decrease) in Cash	(100000)	(100000)	(100000)	(100000)	(100000)
Opening Cash Balance	1000000	900000	800000	700000	600000
Closing Cash Balance	900000	800000	700000	600000	500000





Circuit, City

International practice. Circuit ROI referential model

Track Area	2.200 sq. m
Min. required Height	5 lin. m
Track Length	340 lin. m
Avg. Speed	35 km/h

Session Time	7 min
Hourly Capacity	128 go-karts/h
Go-kart Fleet size	34 go-karts
Recommended price/ride	14,00 EUR
Avg. Occupancy rate	45%

FAMILY & CORPORATE TRACK

5

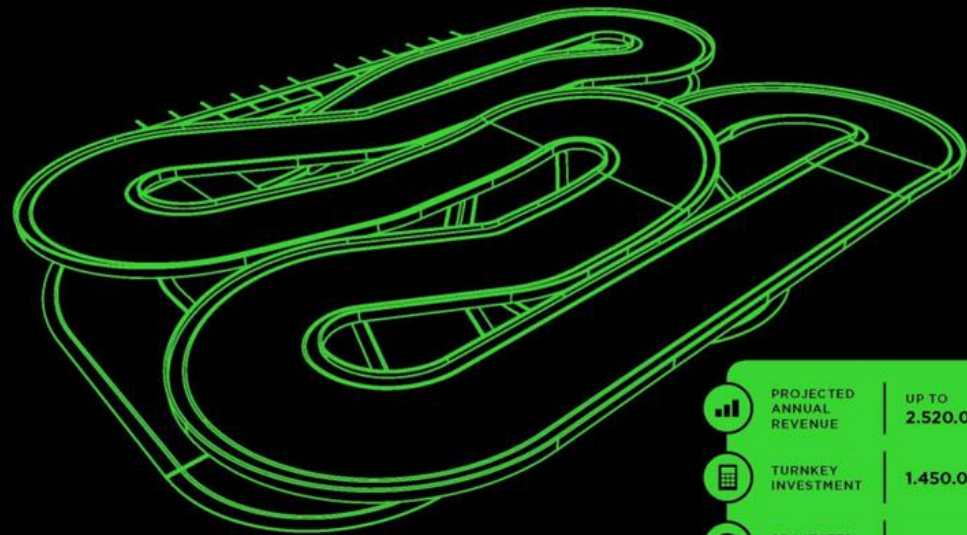

PROJECTED ANNUAL REVENUE	UP TO 2.520.000 EUR
TURNKEY INVESTMENT	1.450.000 EUR
PROJECTED	12 months





spMotoPark City circuit, AI (100x40x12 m)

Track's layers	2
Track area	4000 sq.m
Track length	630 m
first layer	350 m
second layer (overpass)	280 m
Fleet size	34
Hourly capacity	up to 128 ev/h
Average price per ride	8 euro



spMotoPark City circuit. Framed, fast mounted

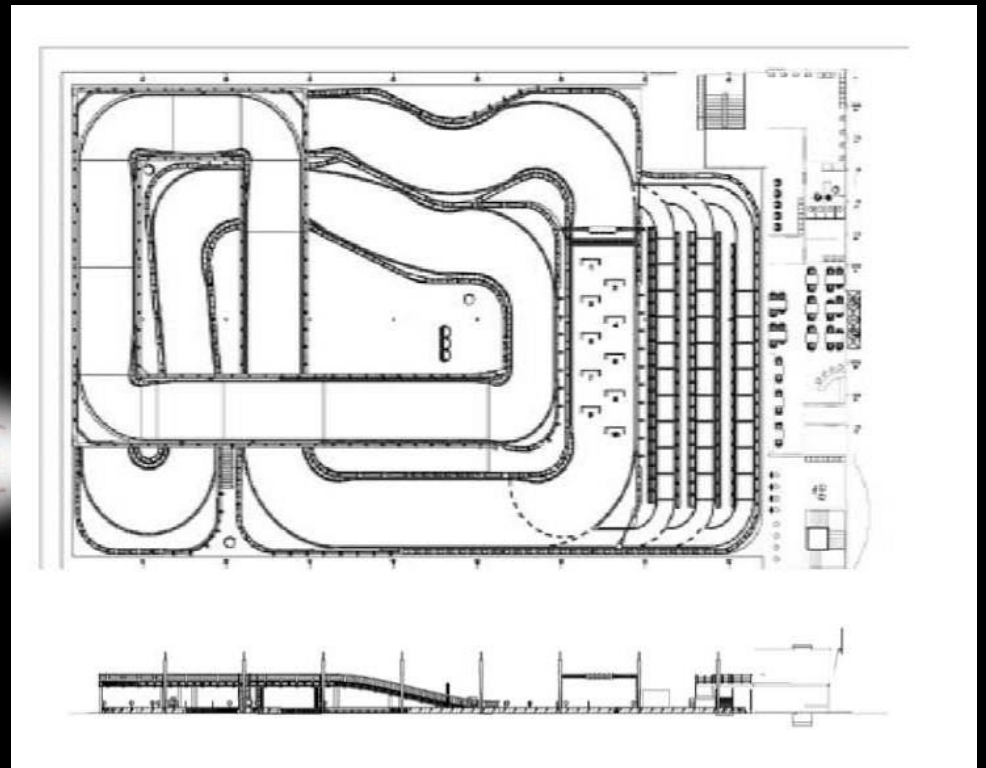
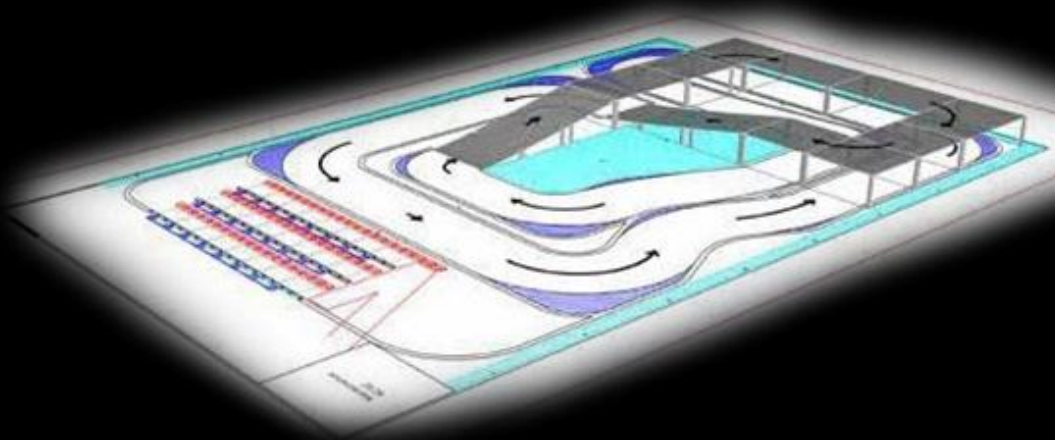



*Start an engine!
Drive yourself*

Written by:

Sergiy Pisarev,
EurAsiaGP, Project Finance & Consulting

orgcom@eurasiagp.org,
office@gpukraine.org,
tel.+41225754749,
+380953647518





ADDENDUM A. Master Plan precedent assessment. Club Format





ADDENDUM A. Master Plan precedent assessment. Club Format





ADDENDUM A. Master Plan precedent assessment. Club Format

#spMotoPark:
master plan selection,
assessment, planning

